

Maintenance Instructions

(ADT927)

Preparation for maintenance or repair service.

1. Open vent valve and isolation valve, (Counterclockwise) push the liquid out of piston cavity by turning the pre-pressurization wheel clockwise until it is completely in.
2. Drain the liquid media out of the pump.
3. Close the isolation valve by turning clockwise until closed.
4. Close vent valve by turning clockwise until closed.

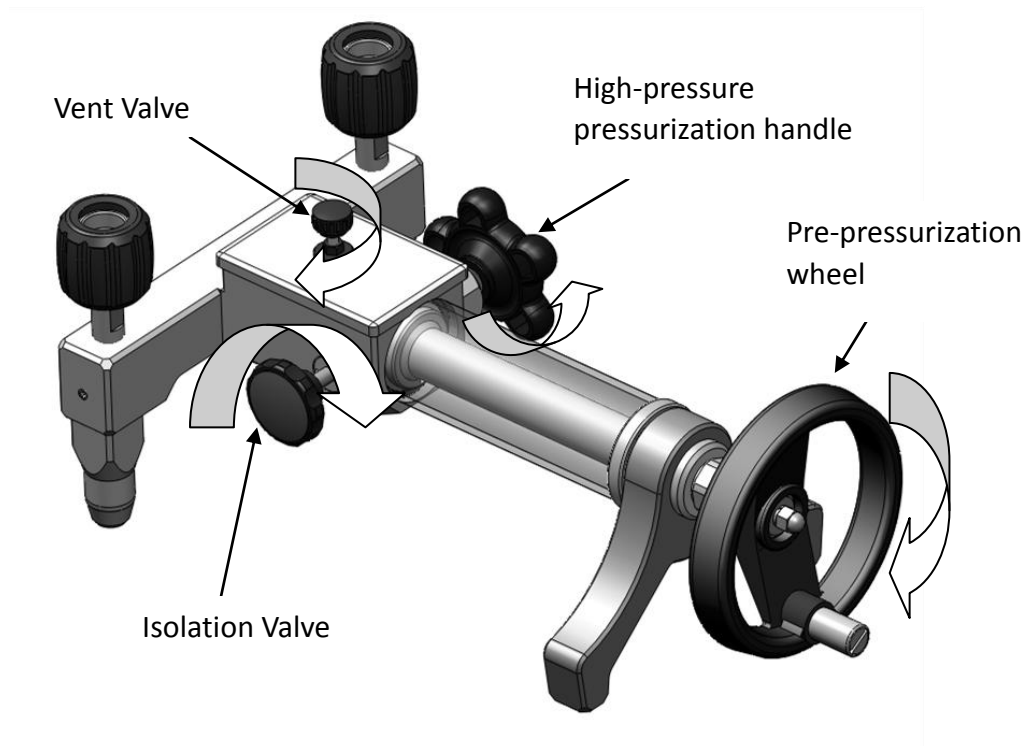

Repairing pre-pressurization piston unit

1. Loosen the Allen screws by turning all three screws counterclockwise 5 to 8 turns.

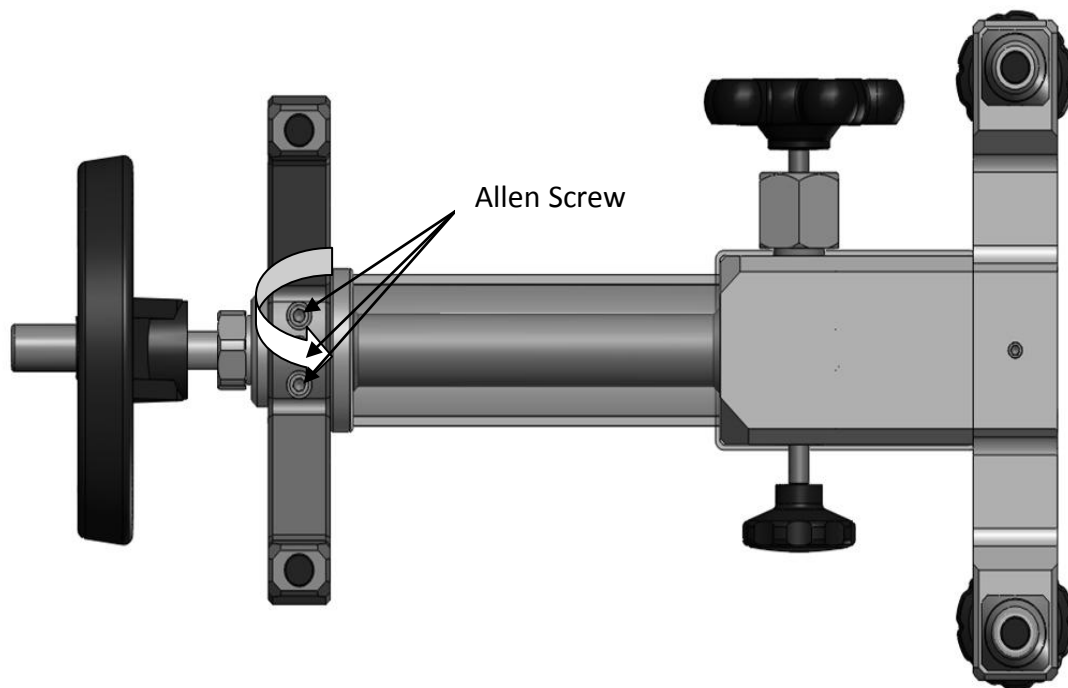

2. Turn out the pre-pressurization wheel to about half way out.

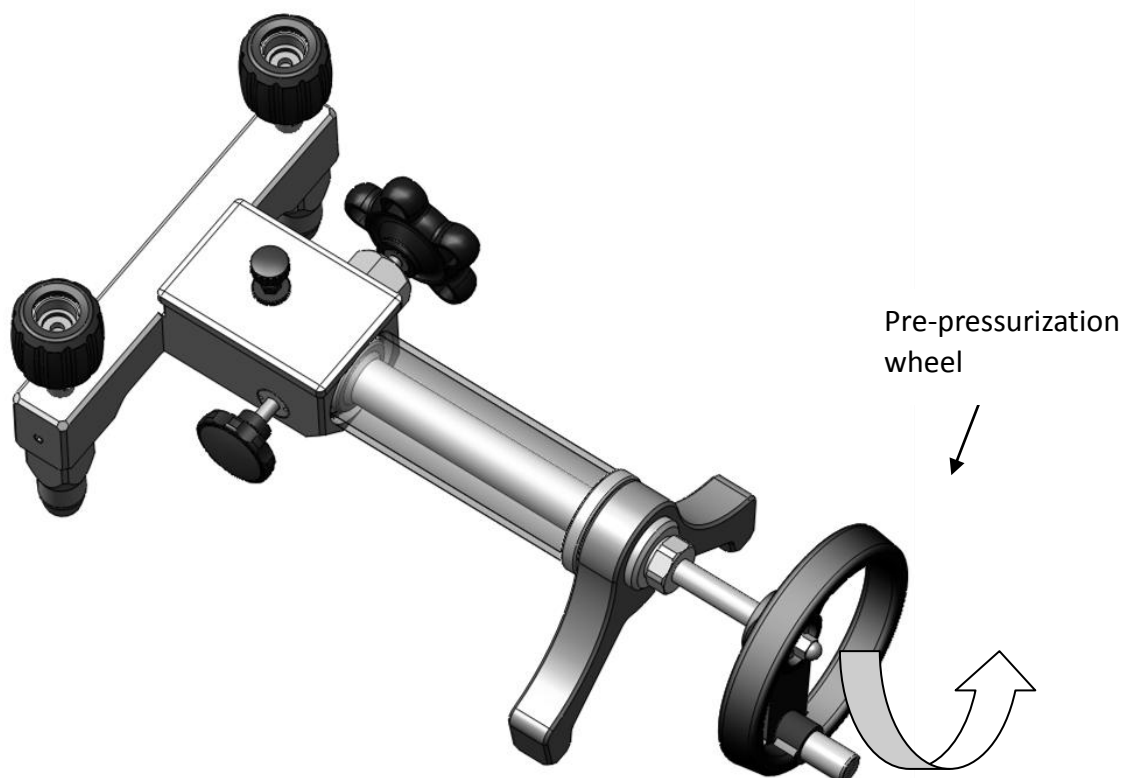

3. Turn the feed screw nut counterclockwise and completely remove the feed screw nut and back holder

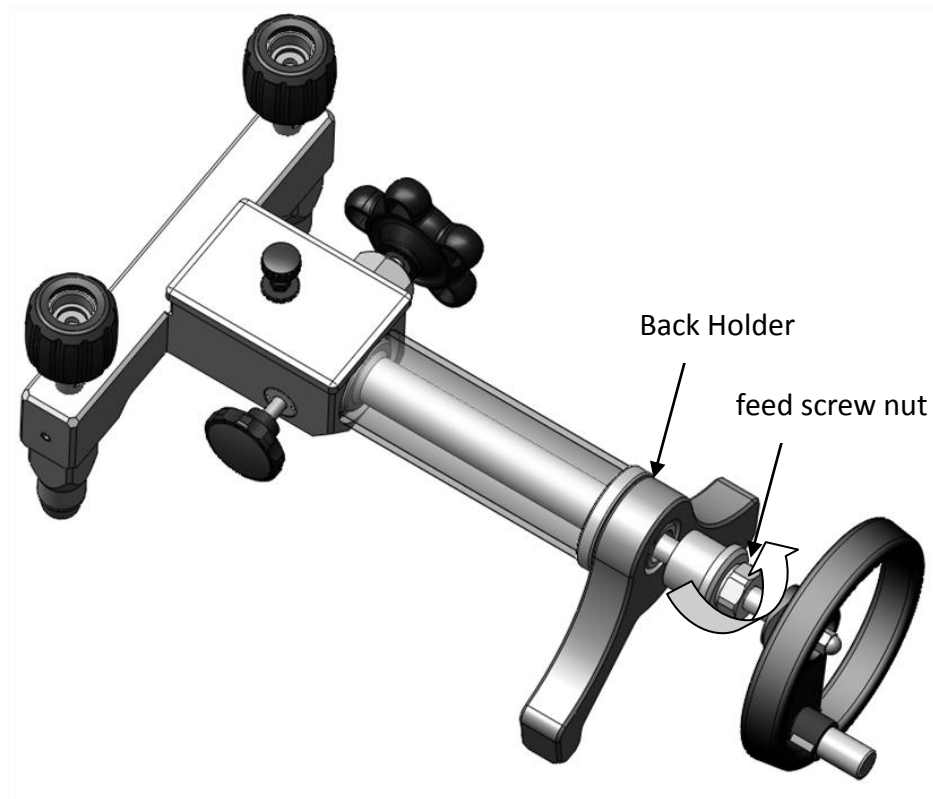

4. Pull the pre-pressurization piston out of the chamber. (*Warning: Be careful not to damage the liquid reservoir during procedure*)

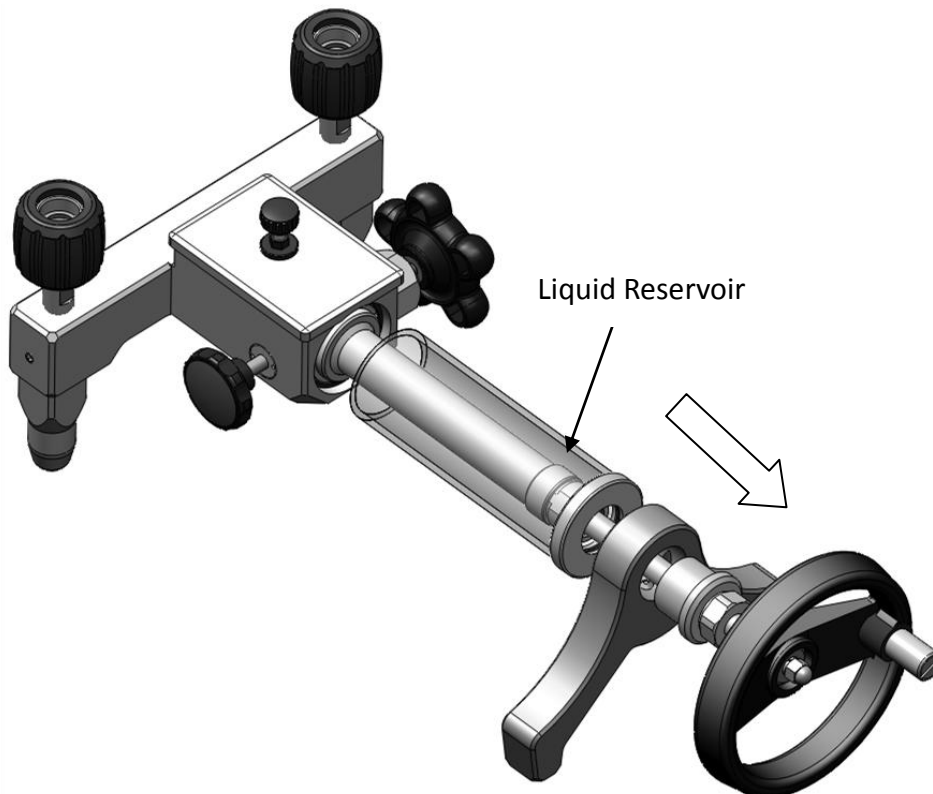

5. Replace the O-ring (9.12mm X 3.53mm).

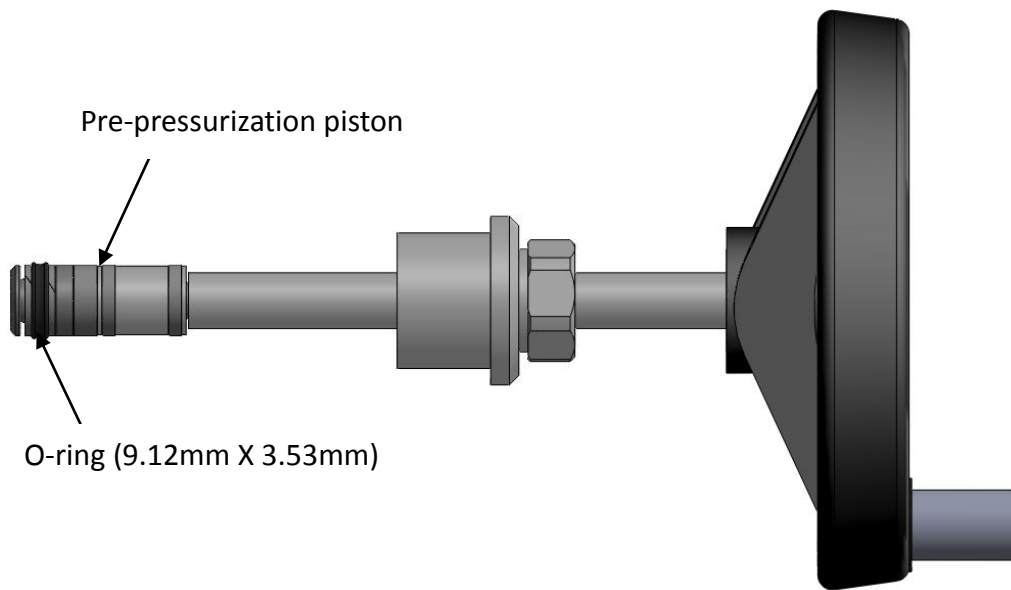

6. Assemble all parts back in reverse order.

Repairing high-pressure pressurization piston unit

1. Turn the high-pressure pressurization wheel counterclockwise to about half way out.

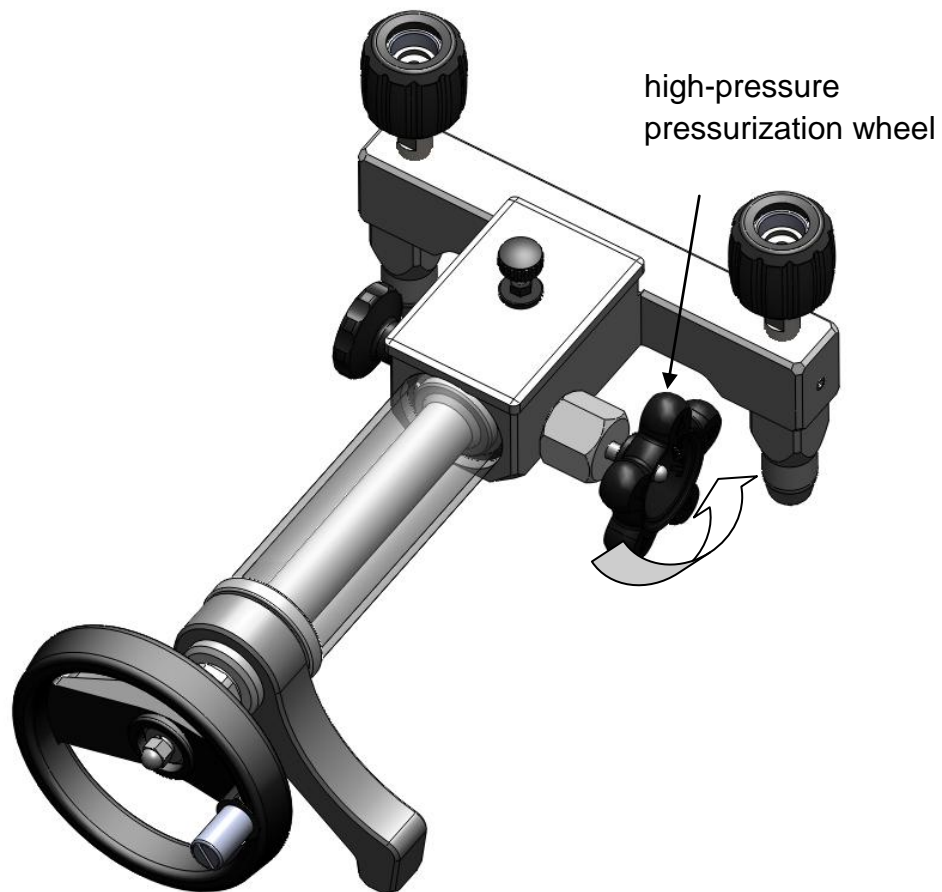

2. Turn the hex nut counterclockwise until completely out.

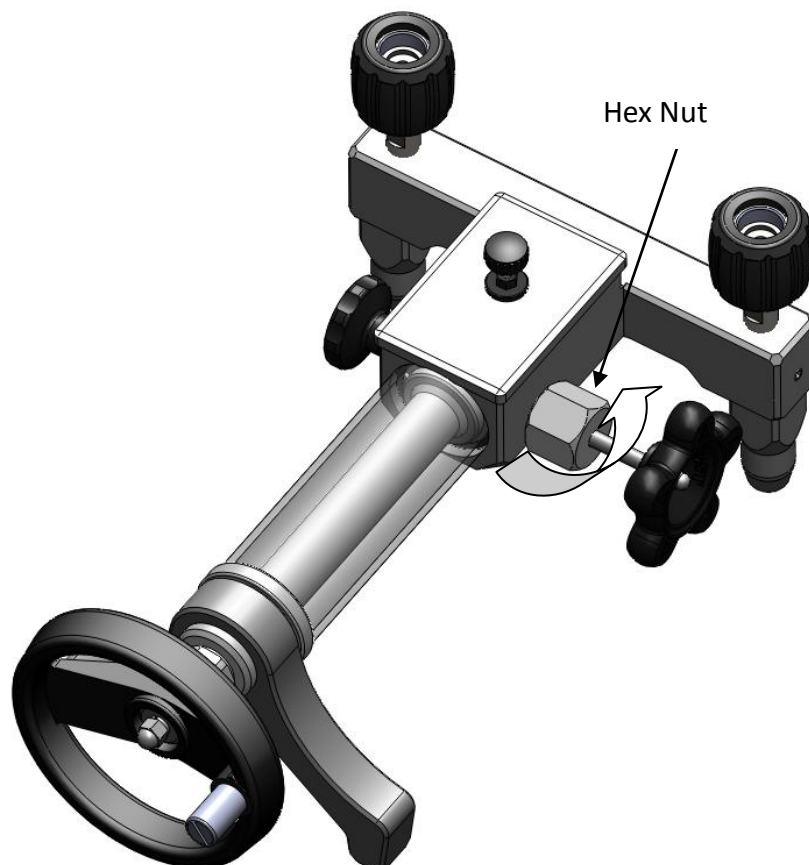

3. Hold the high-pressure pressurization wheel and pull the piston unit out of piston chamber.

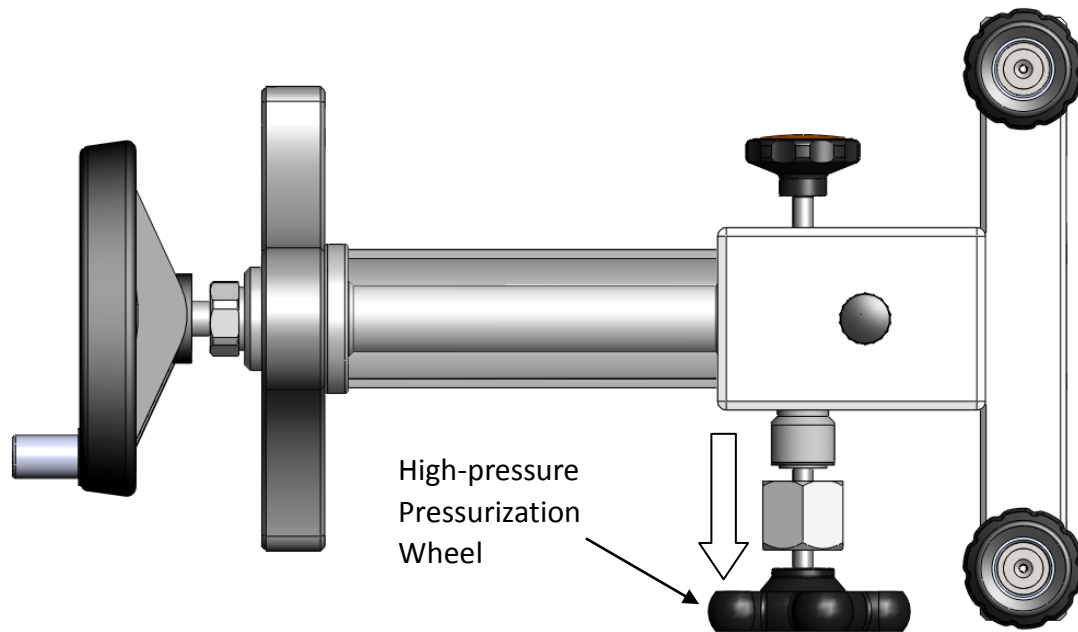

4. Turn the hex nut cover counterclockwise and completely remove it.

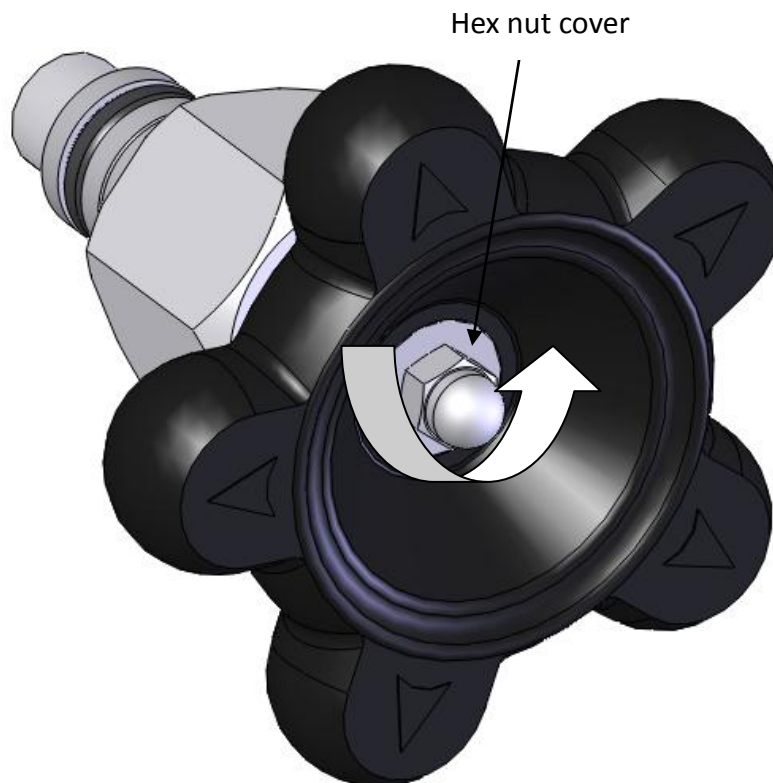

5. Replace the O-ring. (6mm X 3mm)

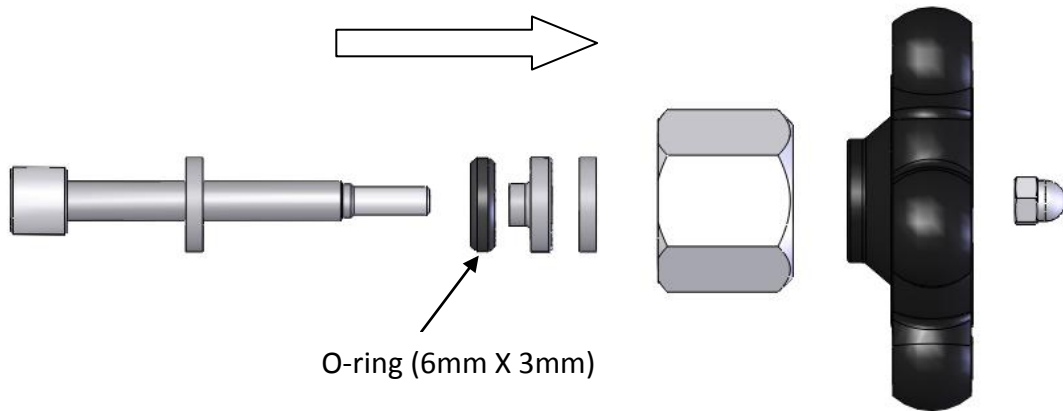

6. Assemble all parts back in reverse order.